

Manual for Carbon Golf Trolley GT-C & GT-CR



Do not throw away the original trolley box and packaging, but keep them for save shipments in the future!!



Attach the rod of the front wheel with a small Click System an das Motorframe.

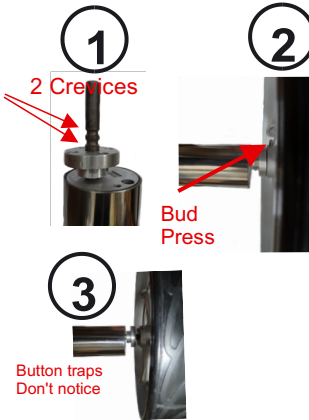

Attach wheels;

There is a button on the wheel (2). Press it and pull it over the stem with grooves. (1) Make sure the 4 buttons fall into the 4 holes. Now the wheel is coupled to the engine. (Maybe a little squeamish at first, but first we need to wear out a bit. After 10x it goes well) Press the button again and pull the wheel back slightly, then it falls into the other groove (1) and the wheel is in the Frei lauf vr (3). In the freewheel you can push the car yourself more easily. Always handy if you forget to charge the battery.



At the top of the folded tube is a button. Pull it off well and first move the thrust tube to the side and

Then until it is at the right height that works well and press the button together again.

In the beginning it is a bit difficult, especially after loosening the 2 components (see arrow) a bit.



Click the performance card support in the bar.



1

The umbrella holder is screwed into a ring. The ring has a raised edge on the inside. Pull the ring over the bar (1) with the outer edge. **Hold the ring** with your thumb and press the umbrella holder. Twist the bracket and push the bracket down (2) if you are walking without rain.

2



If it rains, soften the holder, pull it up and press it very well, if necessary with 2 hands. Then it storms. Pull the ball down with elastic, umbrella on the inside and elastic on the side so that the umbrella cannot be left out

Especially in the beginning, everything will feel a bit stiff and steep. But if you have used the car several times, it is much easier. The matches have to be played together a bit first.

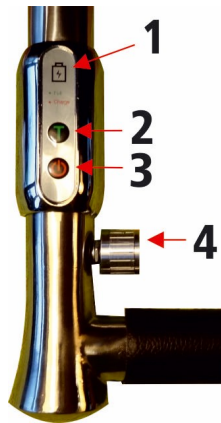

Turn it on. Button three, five seconds.

- 1. Indication of the flow rate.** If the chandelier is green, there is electricity on it.
When it flashes red, the battery is half empty. At constant red light, the battery is empty and the cart stops. Immediately turn off the cart and push further. Getting the bikes outside is easier.
Then charge the battery as soon as possible.
- 2. Advanced action.** Press once and the car moves forward 10 meters and stops automatically. 2x pressing is 20 meters. If you accidentally press the green button, quickly press the red button.
- 3. Red button. When the car is set in motion with the dial 4 and the red button is pressed, the car stops immediately. Then press the red button again and the car will drive at the same speed as before the exit. I recommend using this button as much as possible. It's much quieter.**
- 4. Speed.** Turn the knob to determine the correct speed.
- 5. Turn slowly, otherwise the car will drive too fast.**

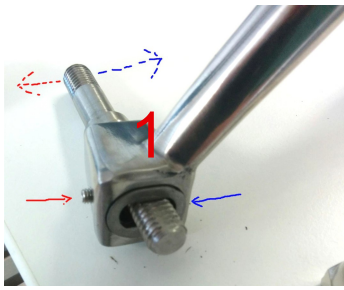

Vorderraddrehungen:

When the front wheel pulls left or right, the axle becomes slightly inclined. This can be solved by loosening the wheel, which is set to 1, + screwing the 2 canisters. Move the tree in the right direction and press the wheel.

Then reattach the 2 hexagonal screws.

There is a video on the Internet about the

orientation of the front wheel.

<https://www.golfted.nl/klantenservice/veel-gestelde-vragen/voorwiel-uitlijnen>

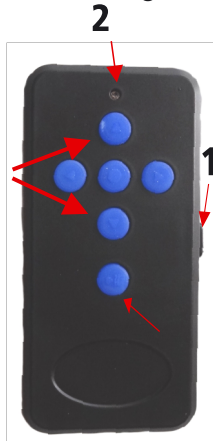

Remote control (GT-CR only)

1. Cursor/Off. Turn off the remote control before inserting it into the jug. Turn it on if you want to use it again. In this way, the cart does not work if the folds of the pants accidentally press a button.
2. The light turns red when you press a button.
3. Control knob and. Briefly tap a command.
4. Drive 10-20-30 meters ahead and stop automatically. This button is never used.

If you are running with the remote control and no button is pressed within 40 seconds, left, right, front or rear, the car suddenly stops automatically. It is an integrated safety measure.

On the website, under "Manuals", there is a video on how to work and how to walk with the remote control.

Connection to the remote control.

Most new trolleys already have the included remote control.

Cart off, both sockets, the speed dial turns backwards and the remote control off. Hang on.

The two switch into the car, **but don't set the car on fire!**

Turn on the remote control and press button 2 (the red light will be pressed), press and hold the button and meanwhile turn on the shopping cart with the red button on the control panel. Within seconds, the car is driving and the remote control is connected.

Tips to keep the lithium battery in perfect condition:

- After 18 holes, the battery can be charged immediately. Empty batteries have a much shorter lifespan.
 - Ensure adequate ventilation while charging (no closed cabinet) – Leave the battery horizontal while charging.
 - The red light is charging, the green LED is that the battery is full.
 - If the battery is not used for a long period of time, it is better if the battery is charged and stored in a dry room without gel.
-
- Never completely discharge the battery. When the battery is empty, the car stops. Never try to drive further on the battery. Turn off the car and press on. Take the wheels out. Charge the battery as soon as possible and do not drain it.

The warranty for lithium battery and charger is 2 years and is used in normal use.

The warranty does not apply to

- Discharge the battery from the battery if it is overused.
In other words, once the battery runs out, try to keep riding on the battery. Or do not charge the battery immediately after it runs out. A weak battery discharges very slowly to 0% and then it fails.
- Store the vacuum capacity for a longer period of time.
- Damage caused by overheating while charging.
- Use of the battery after the damage has occurred and has been detected.
- When the battery (usually with a cart) ends up in the water.
If it turns out that the battery is damaged by any of the above points after the test and therefore cannot be replaced, the test fee will be charged.

Maintenance of the electric axle trolley:

- After a game of golf, clean the car with a damp cloth, - Never evaporate the car with water or water under high pressure. - Never lubricate the racing parts with oil. Just being clean is much better

Addendum to the instructions for use.

Please carefully review the additional points listed here for the GolfTed Trolley. A lot of information can also be found on our website under "Frequently Asked Questions (FAQ)", some of which are also supplemented with short videos on YouTube.

Do not throw away the original trolley box and packaging, but keep them!!

For the models: GT-N, GT-R GT-C & GT-CR

- After unpacking your new trolley, fully charge the battery until the LED light on the charger is green. You can go up to 36 holes with a full battery. If the battery runs out a little earlier and the red light is permanently on, you can click the wheels out of the drive shaft (motor clutch) and simply press them as with a normal trolley or use the trolley in the free wheel. If you purchased a model with a remote control, bring a set of spare batteries (AAA) with you. This is recommended because experience has shown that the manufacturer's standard batteries only last a limited time or are not particularly powerful.
- For safety reasons, you must run your trolley at a maximum distance of up to 8 meters in front of you when using it with the remote control. If the batteries weaken, the remote control no longer covers long distances!
- After using your trolley, always unscrew the battery cable and disconnect the battery from the trolley, otherwise the trolley will continue to use energy from the battery and drain slowly!
- If you are using a remote control, always turn it off before inserting or pressing it (switch down). This is to prevent your trolley from moving if your movement accidentally presses a button on the remote control, in your pocket or jacket.
- If your trolley travels a lot to the left or right, you need to adjust the front wheel slightly - see manual or video on YouTube.
- Only press one button on the remote control at a time and they don't press too fast or several buttons at once, otherwise the cart could stop because it doesn't know what to do anymore. If you do not give commands on the remote control within 40 seconds while walking, the shopping cart will also stop automatically for security reasons.
- Clean your shopping cart regularly (manually) to extend its preservation and service life. Do not use a high-pressure water or air sprayer for cleaning. This can cause damage to the coating or connecting parts.
- The stainless steel scorecard holder clicks on the top frame of the trolley, it can move slightly to the left or right, but is firmly attached and certainly does not fall off.

- Screw the stainless steel umbrella holder the first time you use it, place it on the tube on the handle and tighten it firmly with 2 hands. It does not break when tightened tightly and firmly. After use, unscrew slightly, press and tighten again.

GT-AR, GT-C & GT-CR

Also screw the stainless steel umbrella holder – as described above – tightly. We have placed a piece of black tape next to the handle, so you can better tighten the umbrella holder. When tightening the large knob, make sure that it sits well in front of the hole (or clicks into place), and then tightens tightly.

If you don't have a normal golf bag, but a carrying bag with fold-out legs, the frame can leave minor damage to the two bag holders on your trolley after a few rounds of golf. In this case, we recommend that you additionally equip the bag holders with a piece of commercially available black or transparent hose. This prevents possible damage caused by the coupling of the carrying case.

When placing the "Scorecard Holder" press it down at a 45-degree angle on the Middle Handle frame.

General

- Always test the cart with a full golf bag on it. Without a golf bag, the trolley reacts quickly and steering becomes more difficult!

- **DO NOT immerse** the car in water. The Golf Trolley is not suitable for this. A (mild) rain shower, on the other hand, can't hurt.
- DO NOT use high pressure water or air purifiers to clean the cart.
- The trolley can also be used in the rain. In case of heavy rain, it is best under an umbrella that the control panel, battery and remote control are not waterproof. So in the event of a cloudburst or heavy rain, turn off your trolley and place it in the freewheel.

Warnings and advice

- **Warning:** If your trolley has fallen into the water or suffered water damage due to heavy rainfall, your battery should not be charged as there is a risk of spontaneous combustion or fire!!
- **Note:** Always make sure that the pins of the battery connector do not come into contact with metal objects. This can lead to electric shock and possibly injury.
- **Tip:** We think it is advisable to use the cruise control button in normal use and NOT the remote control, at times when you need to operate the Golf Trolley carefully. Think of fellow players, parking spaces, water nearby and narrow bridges.
- **Recommendation:** Store the charged battery in a warm and dry place (preferably at room temperature), i.e. not on a concrete floor or in a cold car or unheated rooms).

Packaging instructions Carbon Trolley.

Arrange the individual parts as shown in the photo. Under the ash there are 2 blocks of white foam for the substrate. There is a cardboard box between the wheels. The front wheel with rod sits on the floor and is simple with a few white foam blocks so that it does not slip.



Now fill the box with the 2 small boxes. Place the battery, battery charger, and card mount in a box. Plastic bag on the front wheel so that it does not come up.



Place the long piece of foam as shown in the photo. Fold the bag and put it on the wheels.

Cover and glue it tightly with adhesive tape. If you paste the shipping note correctly, the box is ready to ship.





Now that you have a trolley of Golfted.com, you can use the special coupon to buy this waterproof golf bag with hard plastic club diver with a discount of 50 €. This rabat code is: GTGTT2022. More information can be found on our website!





GT-CR



GT-C



GolfTed.com
Menno Bakker & Stef Buizer

Team GolfTed
Helderseweg 29F
1817BA ALKMAAR
NETHERLANDS

Phone: +31 6 22223303
Info@golfted.com
www.golfted.com